



GROUP		Standby Power	Prime Power
Power	kVA	165	150
Power	kW	132	120
Engine Speed	rpm	1500	
Standard Voltage	V	400 / 230	
Power Factor	Cos Phi	0,8	

Continuous Power

The maximum power which a generating set is capable of delivering continuously whilst supplying a constant electrical load. Average load can be 100%. The generator must not be overloaded.

Standby Power

The maxpower available during a variable electrical power sequence, under the stated operating conditions, for which a generating set is capable of delivering in the event of a utilitypower outage or under test conditions for up to 200 hrs of operation per year under average of 70%load.Overloading isn't permissible.

Prime Power

The maximum power which a generating set is capable of delivering continuously whilst supplying a variable electrical load. Average load should be 70%. The generator can be overloaded 10% for 1 hour per 12 hrs.

Engine Properties

Brand		BAUDOUIIN
Model		6M11G165/5
Standby	<i>kW</i>	152
Prime	<i>kW</i>	138
Cylinder Displacement	<i>lt.</i>	6.7
Number of Cylinders / Type		6 / In line
Bore x Stroke	<i>mmxmm</i>	105x130
Compression Ratio		18:1
Governor Type		Electronic
Idle Speed	<i>rpm</i>	1500
Aspiration		Turbocharged Aftercooled
Injection Type		Direct Injection
Cooling System		Liquid Cooled
Fuel Consumption%100	<i>lt/h</i>	32.6
Fuel Consumption%75	<i>lt/h</i>	24.6
Fuel Consumption%50	<i>lt/h</i>	16.7
Oil Capacity	<i>lt.</i>	19
Cooling Liquid Capacity	<i>lt.</i>	17
Voltage	<i>V</i>	12
Battery Capacity	<i>A</i>	60

Alternator Properties

Output Voltage	<i>V</i>	230/400
Frequency	<i>HZ</i>	50
Automatic Voltage Regulation	$\pm\%$	0,5
Phase		3
Pole		4
Overload		1 Hour %110
Voltage Regulation		$\pm\%1$
Power Factor	<i>Cosq</i>	0,8
Warning System		Self Alert
AVR Model		SX460
Total Harmonic Losing		$\leq\%3$
Connecting Type		Star
Protection Class		IP 23
Isolation Class		H

Diemensions

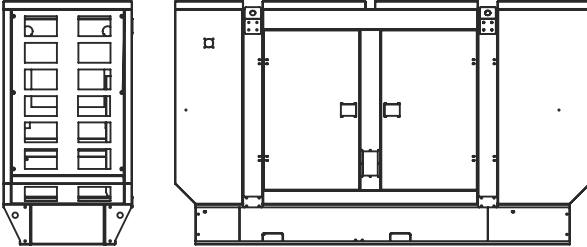

Canopied

L x W x H	<i>mm</i>	3070x1100x1800
Weight	<i>kg</i>	TBA
Fuel Tank Capacity	<i>lt.</i>	245

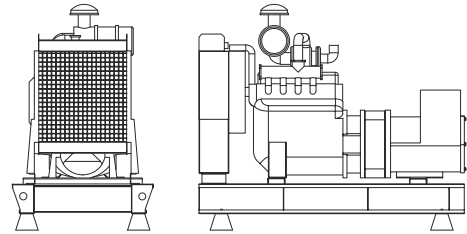

Open Set

L x W x H	<i>mm</i>	2770x1100xTBA
Weight	<i>kg</i>	TBA
Fuel Tank Capacity	<i>lt.</i>	245

Standard Specification

Some standard equipments that TMG POWER provides with generator sets;

- 50°C cooland radiator
- Flexible fuelpipes and oil drain valve
- Engine jacket heater
- 4 pole synchronous type self-excited brushless alternator
- Battery and wires
- Entegrated fuel tank
- User and maintenance manual
- Oil and antifreeze
- Datakom D-300 controller
- Battery charger
- Electrical circuit diagram



- Diesel and gas genset support
- 400Hz operation support
- Downloadable languages
- Harmonic analysis of V & I
- Weekly operation schedule
- Dual mutual standby with equal aging of gensets
- Overload IDMT protection
- Current unbalance protection
- Fuel filling & fuel theft alarms
- Battery back-up real time clock
- Idle speed control
- Contactor & MCB drive
- Fuel filling counters
- Fuel consumption counter
- Automatic GSM geo-location
- Reverse power protection
- Free configuration program
- Mobile genset support
- 3 level configuration password
- Ip65 rating with optional gasket

Optional Specification

Some Optional Equipments that TMG POWER provides with generator Sets;

- Auto refueling system
- Extra fuel tank , coil heaters
- Remote radiator
- Synchronization system
- Circuit breaker
- Special soundproof canopies
- Siesmic solutions
- Trailer
- Remote control panel
- Automatic transfer switch